

the SCOOP

Volume I, Issue 5



May 2006



LIKE PUZZLES?

**LEARN BOTANICAL
NAMES**



Take note of "Hermie"

Inside this issue:

Projects & Committees	2
Puzzle	2
Meeting Minutes	3
Landscape Design	4
Events Calendar	5
Event Report	5
Growing Herbs	6
Meeting Calendar	6
Photo of the Month	7

Listen To Your Lawn

By: A. P. Tuggle

Extension Agent II — Rutherford County

Have you ever thought if your lawn could talk, what would it say. Your lawn can't tell you with words what's wrong but it can send you signals to warn you of certain problems. If you receive one of the signals from your lawn, here's what it's trying to tell you.

White clover – The presence of white clover may indicate the need for nitrogen fertilization. Actively growing lawn grasses usually require more nitrogen than clover. Clover is tolerant of wet, compacted or poorly drained soils and may become competitive during cool wet conditions.

Algae – These minute, single-celled green plants may form a dense green or blackish-green crust on the soil in areas of the lawn with few lawn grass plants. This crust often restricts the movement of water and air into the soil. Algae thrive on compacted, water-logged soils.

Mosses – These small plants often survive a wide range of soil and weather conditions. Mosses may produce a thick, green mass in full sun or shade on both dry and wet soils. They may grow in areas of your lawn where both light and air movements are limited.

Prostrated knotweed – A common problem of many heavily trafficked lawns, playgrounds and athletic fields, this low-growing, summer annual, broadleaf weed is well-

adapted on poorly drained, compacted soils. The plant grows from a thin, long taproot. Wiry, leafy stems that radiate from the root produce a dull, blue-green mat well below the mower blade.

Yellow nutsedge – This grass-like perennial weed with a distinctive, triangular stem is often found growing in infertile soils. Yellow nutsedge is tolerant of wet and poorly drained soils. The best defense against troublesome weeds is a healthy, dense and actively growing lawn. By mowing your lawn often at the appropriate cutting height, fertilizing and liming according to soil test results and core aerifying to reduce soil compaction, you may help provide an environment more favorable for lawn grasses than lawn weeds.

You may increase the amount of light reaching your lawn under tall, isolated trees by pruning limbs below 10 feet. Air movement across the surface of your lawn may be improved by thinning, transplanting or eliminating selected plants growing nearby.

To find out more information, visit our web site at www.utextension.utk.edu/ publications or call the extension office at 615-898-7710. The Extension Service provides equal opportunities in programs and employment. Ω



CHALLENGE

Can you match the following common names to the botanical names in the puzzle?

- | | | | | | | |
|----------------------|------------------|--------------|----------------|--------|-----------|-------|
| Pink Baby's Breath | Texas Bluebonnet | Shrimp Plant | Chenille Plant | Lilac | Daylily | Grape |
| Canterbury Bells | Bird's Nest Fern | Money Tree | Autumn Sage | Cotton | Columbine | |
| Tennessee Coneflower | Bells of Ireland | Burning Bush | Goldenrod | Azalea | Yarrow | |

COMMITTEE ASSIGNMENTS for 2006

- ❖ Phone: Waites, Gibson, Becker
- ❖ Community Projects: Anderson, Chair; R. Gutherz
- ❖ Speakers' Bureau: Richardson, Chair
- ❖ Refreshments: Fladung, Hollingsworth, Dill
- ❖ Special Events: B. Fedorowicz
- ❖ Historian: McCray
- ❖ Public Relations: Miller
- ❖ Web Site Coordinator: Ellis
- ❖ Newsletter: K. Smith, Editor

PROJECTS 2006 Volunteers Needed

1. Garden Basics 2007
2. Brown Bag
3. Diagnostic Clinics
4. Senior Citizen Center
5. Demonstration Garden
6. Bellwood Elementary School Discovery Garden
7. Grape Vines at Lane Agri-Park
8. Orchard at Lane Agri-Park
9. Rain Garden at MTSU
10. Sam Davis Home in Smyrna



PLANT WORD PUZZLE

Q	S	L	G	H	K	Z	N	E	Q	V	R	Z	C	D	Q	O	W	B	N	X	L	A	M	U	G
G	A	D	I	C	T	A	M	N	U	S	A	L	B	U	S	A	I	E	R	C	U	Q	O	D	O
G	L	Q	E	N	W	A	M	I	J	E	Q	L	P	A	U	C	Y	L	C	A	P	U	L	D	S
Y	V	D	J	W	B	R	X	V	K	E	Y	M	R	S	Y	A	A	O	F	M	I	I	I	S	S
P	I	J	Q	A	R	Q	S	H	M	U	U	X	J	P	Y	L	Y	P	V	P	N	L	C	S	Y
S	A	H	E	M	E	R	O	C	A	L	L	I	S	L	W	Y	M	E	N	A	U	E	E	B	P
O	G	T	L	A	M	C	V	X	E	E	K	V	H	E	J	P	Q	R	D	N	S	G	L	Y	I
P	R	R	H	O	D	O	D	E	N	D	R	O	N	N	B	H	X	O	Q	U	T	I	I	Q	U
H	E	N	W	W	V	J	J	N	R	W	C	X	D	I	V	A	D	N	Z	L	E	A	A	K	M
I	G	D	I	C	T	A	M	N	U	S	A	L	B	U	S	H	R	E	B	A	X	N	L	K	V
L	G	L	Z	I	M	P	V	I	T	I	S	C	C	M	W	I	S	G	L	M	E	E	A	N	I
A	I	K	T	R	C	X	Q	Z	P	D	D	H	L	N	N	S	K	U	P	E	N	X	E	W	T
P	I	O	O	M	G	A	L	B	D	Y	F	P	G	I	T	P	R	T	T	D	S	L	V	S	I
A	I	O	I	D	D	S	Y	R	I	N	G	A	Z	D	E	I	S	T	M	I	I	Z	I	O	F
C	D	G	P	L	O	U	G	J	Q	E	B	A	O	U	A	D	B	A	U	U	S	H	S	L	O
I	D	F	Y	Z	S	O	V	S	O	G	H	B	P	S	C	A	F	T	J	M	Q	E	M	I	L
F	B	K	Z	E	A	T	K	U	S	G	I	B	C	X	H	S	X	A	F	I	T	J	K	D	I
I	L	E	U	C	A	L	L	P	T	U	S	P	U	L	V	E	R	U	L	E	N	T	A	A	U
C	E	C	H	I	N	A	C	E	A	T	E	N	N	E	S	S	E	E	N	S	I	S	S	G	M
A	X	X	U	H	I	F	O	L	A	U	A	C	H	I	L	L	E	A	S	G	T	M	N	O	N

- | | | | | |
|-------------------------|---------------------|-------------------------|---------------------|--------------------|
| Syngria | Moliceia laevis | Dictamnus albus | Gypsophila pacifica | Beloperone guttata |
| Hemerocallis | Aquilegia | Salvia greggii | Campanula medium | Asplenium nidus |
| Acalypha hispida | Gossypim vitifolium | Eucalyptus pulverulenta | Rhododendron | Solidago |
| Echinacea tennesseensis | Achillea | Lupinus texensis | Vitis | |

Minutes of Meeting—May 15, 2006 — A. Blanton, Secretary

Master Gardeners of Rutherford County met on May 15, 2006, 6:30 PM at the Lane AgriPark Center in Murfreesboro. President J. Smith called the meeting to order with a welcome to all. He introduced new members who recently completed the Master Gardener Class.

Treasurer's Report: Current Balance \$3,839.44

New Business: A request from B. Davenport, Extension agent asking for the Association to sponsor scholarships to 4-H Camp for those who otherwise could not attend. K. Miller made a motion to donate \$100, seconded by M. Blanton. Motion passed.

Executive Board Action:

- ♦ Approved sending two people to Chattanooga to attend the Jr. Master Gardener Training program to obtain information to use in school programs.
- ♦ Approved payment of registration fees for W. Anderson, K&A Miller to attend the Southeastern Regional Conference In Chattanooga.
- ♦ Continue Fall Extravaganza with W. Richardson agreeing to chair the committee.
- ♦ Garden Basics Class—perhaps holding sessions on Saturday mornings.

E. Arnold and A. Blanton presented quotes for shirts to be worn by members at events.

Story Boards are needed for the conference in Chattanooga. President Smith asked Fedorowicz and W. Richardson to assemble them to include the Progressive Farmer Idea House and Garden Basics Classes.

The new membership directory was distributed.

Projects Committee Reports:

Speaker's Bureau: D. Richardson is creating a group of people who would be willing to go out and talk with people and/or clubs. Presently someone is speaking each month at the St. Clair Senior Center. Fedorowicz is speaking in May, and J. Smith is speaking in June.

Special Events:

- ♦ *May 20*—Field trip to Huntsville Botanical Garden—cost \$8.00. Travel as a carpool and bring sack lunch. Will stop at Bennett's Nursery on the return trip.
- ♦ *May 27*—Field trip to ColorBurst on John Bragg Hwy. Meet there at 9:30 a.m.
- ♦ *June 8-11*—Southeastern Master Gardener's Conference—Chattanooga, TN
- ♦ *June 10-11* — Secret Garden Tour—Members W&D Richardson and M&A Blanton will be garden hosts. Cost is \$10.00
- ♦ *June 24* — Rutherford County Pond Tour B. Jones' and P. Rowlette's ponds and gardens are on the tour. Cost \$5.00

Conference Silent Auction—K. Miller is sending an email to all county agents and Master Gardener Clubs to obtain materials for the auction. He encouraged everyone to come to the conference if only for one day.

Newsletter—J. Smith asked members to submit articles for the newsletter. He challenged everyone to write one article this year or he will volunteer you. Pictures are also requested.

Historian—E. McCrary reported a cabinet had been obtained at the Extension Office, and he is in process of collecting material.

Website—B. Ellis has posted the site. Information such as classes, newsletter, Master Gardener classes are available. ULR is www.mastergardeners-rc.org/

By-Laws Update—Slow progress; will have something for review in 6-8 weeks.

Our speaker this month was Pam Rowlett from Valley Growers, who showed the many new plants available for our area.

Meeting adjourned at 8:40 pm. Ω

W. Anderson Reports:

Rain Garden started in October 2005 was 95% finished April 26, 2006. One of Anderson's Fall 2005 classes started the rain garden, and one of his Spring 2006 classes finished the garden.

The Rutherford County Environmental Education Collaborative (REEC) will be meeting at the Horticulture Center on the MTSU campus June 14 from 12:00-1:00. Don

Galbreath from the Tennessee Dept. of Agriculture will give a power point presentation on rain gardens. The group will then look at the garden next to the Horticulture Center. Mr. Galbreath said it is the first rain garden built in Rutherford County.

Vinyard was planted on April 15th. Two hundred vines were planted 10 ft. apart in 15 ft. wide rows. C. Dill helped plant vines. Anderson & Johnston mowed the grass between rows on April 29.

LANDSCAPE DESIGN - Developing A Base Plan

Fourth In A Series

By: J. Smith, President

Site Inventory & Analysis

Before you can begin any drawing or design work, you have to prepare an inventory of what is already on the property and what may or may not need to be retained. Starting with the Base Plan, lay out what is already on site. This is extremely important if your property is older with many existing features. If, however, your property is relatively new, there will be fewer items you will need to show. The following features are examples of what you need to exhibit on the overlay.

- ◆ Sun & shade areas
- ◆ Storage area locations
- ◆ Other factors that may influence design.

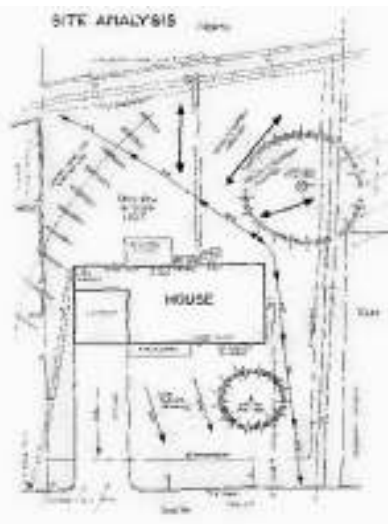

When making a site inventory and analysis it is a good idea to walk around the site making notes and taking photos to illustrate situations, both good and bad. The analysis phase is to determine what of the existing features should be retained, replace, modified or added.

Unfortunately, the typical developer is in the business to build and sell houses. Developers tend to rely on stock building plans and limited stock landscape designs. They rarely take into consideration existing features, sun or shade, wind, sounds, sights or any of the many factors that you, as the owner, will want to take into consideration. Creativity in landscape design is not their long suit. Ω

- ◆ Elevation & direction of slope
- ◆ All existing trees, shrubs, beds, etc.
- ◆ Prevailing wind direction
- ◆ Sights, sounds, directions
- ◆ Soil types, particularly if site is large

Word Puzzle Solution

Q	S	L	G	H	K	Z	N	E	Q	V	R	Z	C	D	Q	O	W	B	N	X	L	A	M	U	G
G	A	D	I	C	T	A	M	N	U	S	A	L	B	U	S	A	I	E	R	C	U	Q	O	D	O
G	L	Q	E	N	W	A	M	I	J	E	Q	L	P	A	U	C	Y	L	C	A	P	U	L	D	S
Y	V	D	J	W	B	R	X	V	K	E	Y	M	R	S	Y	A	A	O	F	M	I	I	S	S	
P	I	J	Q	A	R	Q	S	H	M	U	U	X	J	P	Y	L	Y	P	V	P	N	L	C	S	Y
S	A	H	E	M	E	R	O	C	A	L	L	I	S	L	W	Y	M	E	N	A	U	E	E	B	P
O	G	T	L	A	M	C	V	X	E	E	K	V	H	E	J	P	Q	R	D	N	S	G	L	Y	I
P	R	R	H	O	D	O	D	E	N	D	R	O	N	N	B	H	X	O	Q	U	T	I	I	Q	U
H	E	N	W	W	V	J	J	N	R	W	C	X	D	I	V	A	D	N	Z	L	E	A	A	K	M
I	G	D	I	C	T	A	M	N	U	S	A	L	B	U	S	H	R	E	B	A	X	N	L	K	V
L	G	L	Z	I	M	P	V	I	T	I	S	C	C	M	W	I	S	G	L	M	E	E	A	N	I
A	I	K	T	R	C	[Q	Z	P	D	D	H	L	N	N	S	K	U	P	E	N	X	E	W	T
P	I	O	O	M	G	A	L	B	D	Y	F	P	G	I	T	P	R	T	T	D	S	L	V	S	I
A	I	O	I	D	D	S	Y	R	I	N	G	A	Z	D	E	I	S	T	M	I	I	Z	I	O	F
C	D	G	P	L	O	U	G	J	Q	E	B	A	O	U	A	D	B	A	U	U	S	H	S	L	O
I	D	F	Y	Z	S	O	V	S	O	G	H	B	P	S	C	A	F	T	J	M	Q	E	M	I	L
F	B	K	Z	E	A	T	K	U	S	G	I	B	C	X	H	S	X	A	F	I	T	J	K	D	I
I	L	E	U	C	A	L	L	P	T	U	S	P	U	L	V	E	R	U	L	E	N	T	A	A	U
C	E	C	H	I	N	A	C	E	A	T	E	N	N	E	S	S	E	E	N	S	I	S	S	G	M
A	X	X	U	H	I	F	O	L	A	U	A	C	H	I	L	L	E	A	S	G	T	M	N	O	N

June 2006 Events



Sun	Mon	Tue	Wed	Thu	Fri	Sat
				1	2	3
4	5	6	7	8 *SR.MG Conference	9 *SR.MG Conference	10 *SR.MG Conference *Secret Garden Tour
11 *SR.MG Conference	12	13	14 *Rain Garden Presenta- tion & Tour	15	16	17
18	19 *Monthly Meeting Master Gardeners	20	21	22	23	24 *Pond & Garden Tour *Iris Sale *Daylily Sale
25	26	27	28	29 *Bonsai Show	30 *Bonsai Show	

Schedule of Events

- **May 27** – MG Trip to ColorBurst Nursery. John Bragg Highway Murfreesboro. Meet at ColorBurst at 9:30 a.m. This nursery is not open to the public.
- **June 8-11** – Southern Region Master Garden Conference—Chattanooga, TN
- **June 10-11** — Secret Garden Tour — Murfreesboro, TN
- **June 14** — Rain Garden Presentation & Tour — MTSU Horticulture Center
- **June 19** — Master Gardener Monthly Meeting — 6:30 pm
- **June 24** — 12:00-1:00 Pond Garden Tour — Murfreesboro, TN
- **June 24**— Mid-State Iris Society Rhizome Sale—Cannonsburgh Village— Murfreesboro, TN
- **June 24** — Daylily sale — Cheekwood Botanical Gardens — Nashville, TN
- **July 29-30** — Bonsai Show & Competition—MTSU Keathley Center, Murfreesboro, TN

Event Trip—Huntsville Botanical Gardens — B. Fedorowicz

Fourteen members had signed up for the trip to the Huntsville Botanical Gardens in Huntsville, AL. Because of scattered storms and 60% chance of rain attendance dropped to four Master Gardeners, the Fedorowiczs and Lehtos.

They arrived at the Gardens just in time to tour in their golf cart. The driver was very hospitable, stopping to let them off to take pictures and for close-up views of the flower beds.

After the tour and lunch they proceeded to Bennett’s Nursery and arrived just in time for a free chicken bar-b-que with drinks. A bluegrass concert (another freebee) was enjoyed.

Bennett’s had at least 14 greenhouses with excellent selections of

plants. After a delightful day, the group returned around 4:30 pm. Ω



Huntsville Botanical Gardens—Huntsville, AL



Huntsville Botanical Gardens—Huntsville, AL



Rescued Dogwood Tree
Huntsville Botanical Gardens—Huntsville, AL

GROWING HERBS

First In A Series

By: B. Fedorowicz

Growing herbs has been a pleasant hobby for quite some time. I enjoy herbs because they are multi-functional, as well as being aromatic and make excellent gifts. I enjoy cooking with them.

Growing conditions are similar to that of a vegetable garden. You want good drainage and at least six hours of daily sunlight, although there are a few herbs that will grow in a shaded area. Know the sunlight requirements before you purchase or ask your nurseryman. Ideally, the herb garden should be near your kitchen door for quick access, but you can also mix them in with your vegetables.

Herbs can be grown in pots, but the best situation would be to plant your herbs directly in the ground. This will keep the roots cooler in the summer and help them retain moisture. The roots can really spread out, and may get root-bound in a pot. Potted herbs will need to be watered daily and sometimes twice if it is really hot.

Harvest time is almost immediate. One should not wait until fall as the plants may get woody and have a bitter taste. Young leaves and flowers are most desirable.

Wash the herbs early morning while still on the plant or remove the leaves and wash indoors. Take the outer leaves on your parsley, as the plant will produce new



B. Fedorowicz Herb Garden

from the center. Trimming your herbs will encourage them to grow and produce new leaves.

It is always best to use herbs while fresh and adding them as your last ingredient when your recipe is almost finished cooking. Taking the pot off the stove and tossing in the herbs will bring out the flavor. One will need a good deal more herbs when using them straight from the garden.

Mix the herbs with butter, put in a container, or roll into a log with waxed paper. They are ready for garlic bread, pasta, soups, vegetables, etc.

Dried herbs should be added early in a recipe as they need to be reconstituted. Notice that your recipe calls for measuring by the teaspoon versus a hand full or measured cup if fresh. To dry herbs pick early in the day, wash and dry. Tie them with a rubber band to allow for shrinkage. Hang them out of the sun in an area with good circulation. The herbs should be ready for packaging within a few days. Crumble the foliage and store in air-tight containers. Be sure to label and date the herbs.

Plant the following if you like:

Italian Food: oregano, parsley, garlic, marjoram & basil.

Mexican Food: cumin, marjoram, & garlic. Ω

MEETING CALENDAR FOR 2006			
MONTH	DAY	PROGRAM	REFRESHMENTS
January	23	Agent Tuggle—Projects	Fladung, Hollingsworth, K.Smith
February	20	M.Vehr—ColorBurst Nursery	Miller, Gibson, Dill
March	20	Agent Tuggle—Diagnostics Labs	Gutherz, Jones, Hines
April	17	C.Owen—Blooms Nursery NOTE: plant swap cancelled	POT LUCK
May	15	P. Rowlett—Valley Growers	McCrary, Fedorowicz, Arnold
June 	19	TBA	W.Richardson, Ellis, Norfleet
July	17	C. Holloway—M'boro City Horticulturalist	Selby, Massquoi
August	21	TBA	POT LUCK
September	18	TBA	W.Richardson, Gutherz, Fladung
October	16	TBA	Ellis, Fedorowicz
November	18	M.Nevills—Edu. Dir. Oakland Mansions	Arnold, Dickson, P.Richardson
December	19	TBA	POT LUCK

Featured Photo of the Month

CONGRATULATIONS M BLANTON

M. Blanton, as most of you know, is an avid Bonsai collector. He is a certified Bonsai Master and has been featured on the local PBS TV program *Volunteer Gardens*. He is also in demand to speak at events throughout the state. Blanton travels the U.S. to Bonsai Shows and Competitions and always comes away a winner.

The picture to the right shows one of his most recent accomplishments. This beautiful 31 year-old bonsai tree is a *Japanese Procumbens Juniper*, owned and trained by Blanton. This specimen won the Viewer's Choice Award at the Knoxville Bonsai Show held on the UT Campus on May 13 & 14th, 2006.



VIEWER'S CHOICE AWARD Knoxville Bonsai Show
Japanese Procumbens Juniper, owned and trained by M. Blanton.

The Blantons' gardens will be on the Secret Garden Tour June 10 & 11, so be sure to schedule this on your calendar.

TO RECEIVE YOUR MASTER GARDENERS OF RUTHERFORD COUNTY MEMBERSHIP DIRECTORY,
BE PRESENT AT THE NEXT MEETING!

MASTER GARDENERS OF RUTHERFORD COUNTY

Lane Agri-Park
315 John R. Rice Blvd.
Murfreesboro, TN 37129
Phone: 615-898-7710

Newsletter Editor:
Email: ksmith555@bellsouth.net



Programs in agriculture and natural resources, 4-H youth development, family and consumer sciences and resource development. University of Tennessee Institute of Agriculture, U.S. Department of Agriculture, county governments cooperating, UT Extension, and Tennessee State University provide equal opportunities in programs and employment.

"The SCOOP" is the monthly newsletter of the Master Gardeners of Rutherford County, Tennessee and is published the fourth week of each month by email. Those members without email and who are not able to attend meetings may receive the newsletter by U.S. postal mail. The deadline for articles, pictures, events, etc. to be included in the newsletter is the third Friday of each month.

Meetings are held on the third Monday of each month at the Lane Agri-Park at 6:30 p.m., unless specified. Membership is \$25 for a single, or \$35 for a couple residing at the same address. All memberships are valid January through December and are prorated.

Memberships in the Master Gardeners of Rutherford County are open to those interested in learning, teaching, and volunteering for the purpose of educating the community in all phases of gardening.

PLEASE NOTE: MASTER GARDENER CERTIFICATION REQUIRES 40 HOURS OF TRAINING PLUS 40 HOURS OF VOLUNTEER SERVICE. RECERTIFICATION REQUIREMENTS ARE 25 VOLUNTEER HOURS, PLUS 8 HOURS OF CONTINUING EDUCATION PER YEAR. ATTENDANCE AT MEETINGS COUNTS AS 1.5 HOURS FOR CONTINUING EDUCATION AND 1.5 HOURS FOR ADMINISTRATION.